

CONVENTION CENTER MAP

Rooms in red indicate
AHA Scientific Sessions 2018
programming locations.

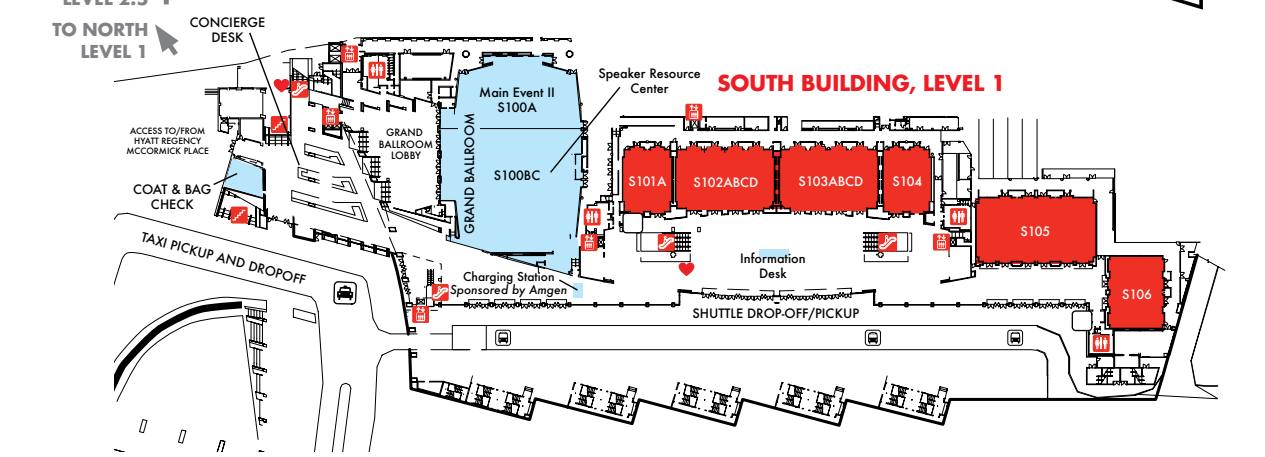
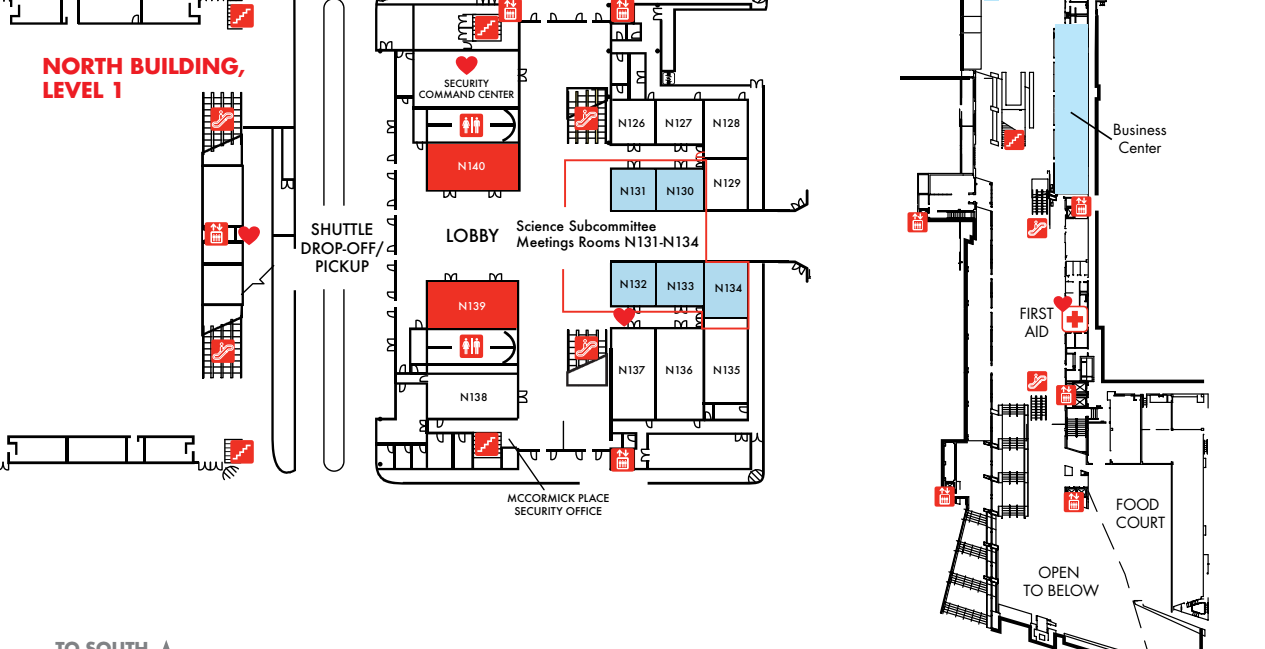
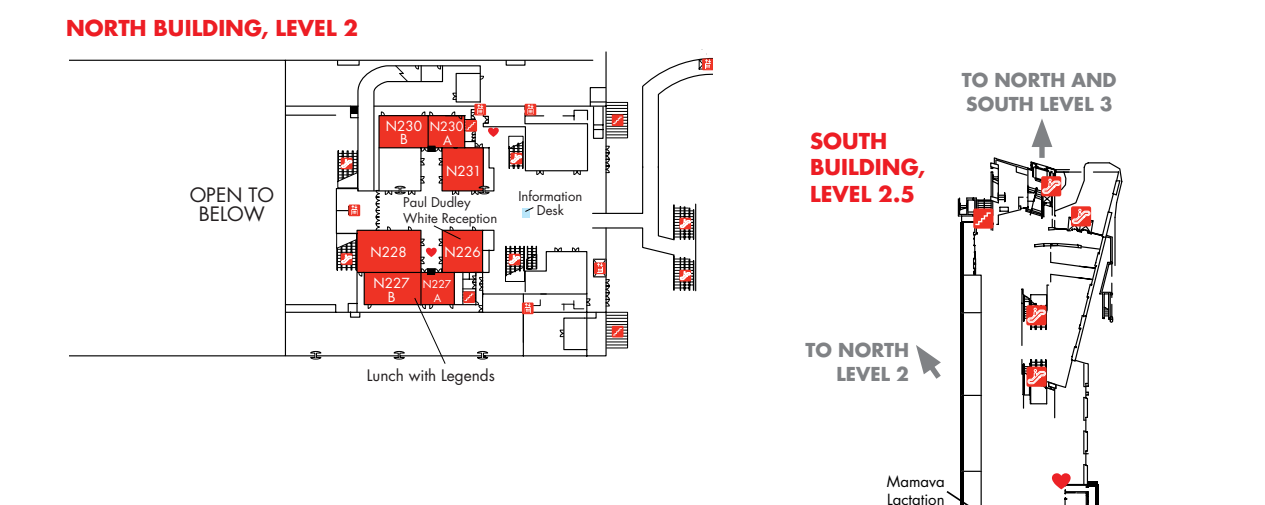
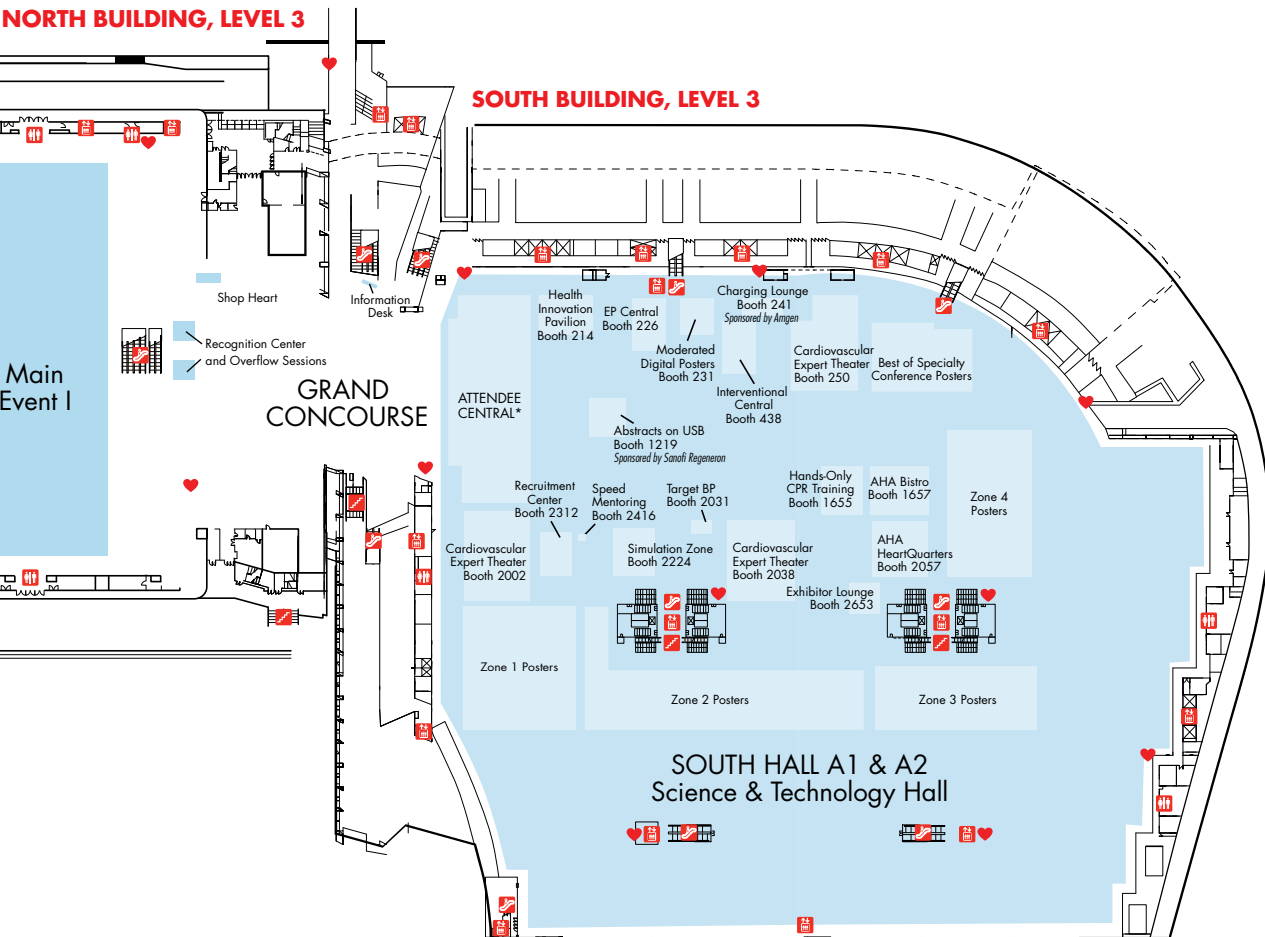
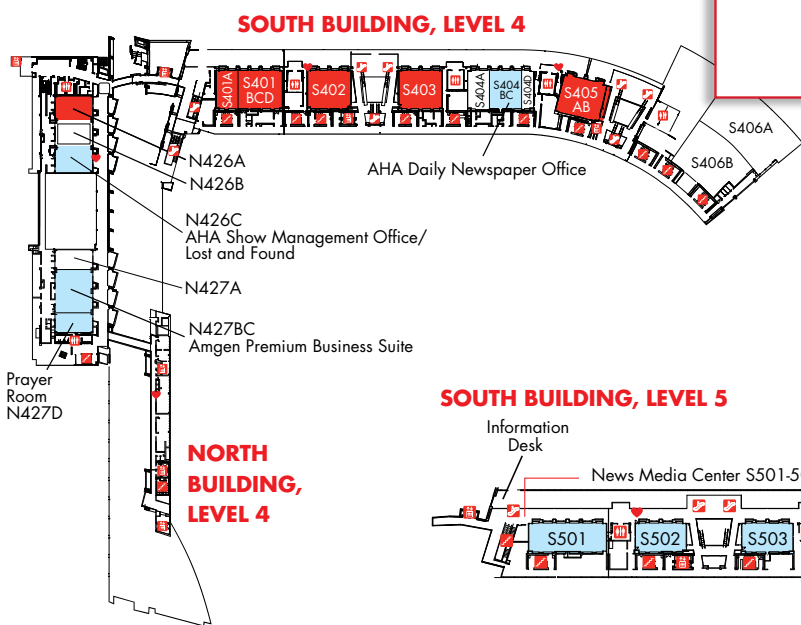
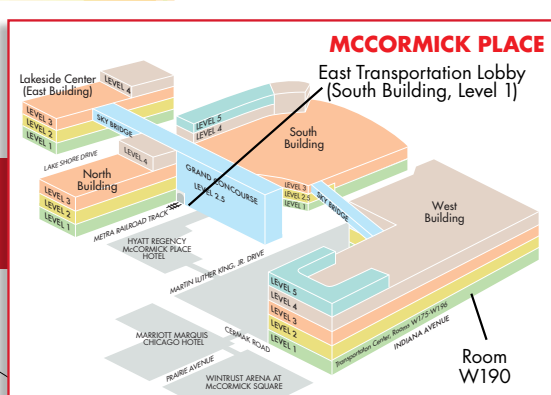

November 10-12 | Chicago, Illinois

scientificsessions.org

AMP UP

YOUR SCIENTIFIC SESSIONS EXPERIENCE

SCIENCE & TECHNOLOGY HALL HOURS

Saturday, Nov. 10: 11 a.m.-5 p.m.

Sunday, Nov. 11: 10 a.m.-4:30 p.m.

Monday, Nov. 12: 10 a.m.-3 p.m.

More can't-miss opportunities

- EP Central
- Interventional Central
- Health Innovation Pavilion
- Simulation Zone
- Complimentary coffee breaks
- Lunch in Cardiovascular Expert Theaters
- AHA HeartQuarters
- Posters integrated throughout the Science & Technology Hall
- Engage with nearly 200 exhibitors
- Hands-Only CPR training
- AHA Bistro
- Complimentary professional photos taken
- Charging Lounge

SHUTTLE BUS INFORMATION

SHUTTLE ROUTES

Gates 1-3 at South Building

Route #1 (Boards at Gate 3): Please allow 15-17 minutes travel time one-way.

Route #2 (Boards at Gate 3): Please allow 20-25 minutes travel time one-way.

Route #3 (Boards at Gate 2): Please allow 20-25 minutes travel time one-way.

Route #4 (Boards at Gate 2): Please allow 15-20 minutes travel time one-way.

Route #5 (Boards at Gate 1): Please allow 12-15 minutes travel time one-way.

Route #6 (Boards at Gate 1): Please allow 20-25 minutes travel time one-way.

Gates 26-27 at North Building

Route #7 (Boards at Gate 27): Please allow 20-30 minutes travel time one-way.

Route #8 (Boards at Gate 26): Please allow 20-25 minutes travel time one-way.

Route #9 (Boards at Gate 26): Please allow 15-20 minutes travel time one-way.

Shuttle service will not be provided from the following hotels that are within walking distance to McCormick Place.

Hyatt Regency McCormick Place • Marriott Marquis Chicago

Please refer to the sign in your hotel lobby for more specific information for your route.

SHUTTLE HOURS OF OPERATION

Shuttle service runs approximately every 20 minutes.

Saturday, Nov. 10

6:30 a.m.-6 p.m. Shuttle provided to/from hotels and McCormick Place

6-7:30 p.m.* Return shuttle from McCormick Place to hotels

Sunday, Nov. 11

6:30 a.m.-6 p.m. Shuttle provided to/from hotels and McCormick Place

6-7:30 p.m.* Return shuttle from McCormick Place to hotels

Monday, Nov. 12

6:30 a.m.-6 p.m. Shuttle provided to/from hotels and McCormick Place

6-7:30 p.m.* Return shuttle from McCormick Place to hotels

*Time last shuttle departs McCormick Place returning to hotels. No shuttle service from hotels to McCormick Place after 6 p.m.



For questions about the shuttle or to make a reservation for a wheelchair-accessible shuttle, please see the supervisor at McCormick Place or call Kushner & Associates at 310-210-2139 during shuttle hours.

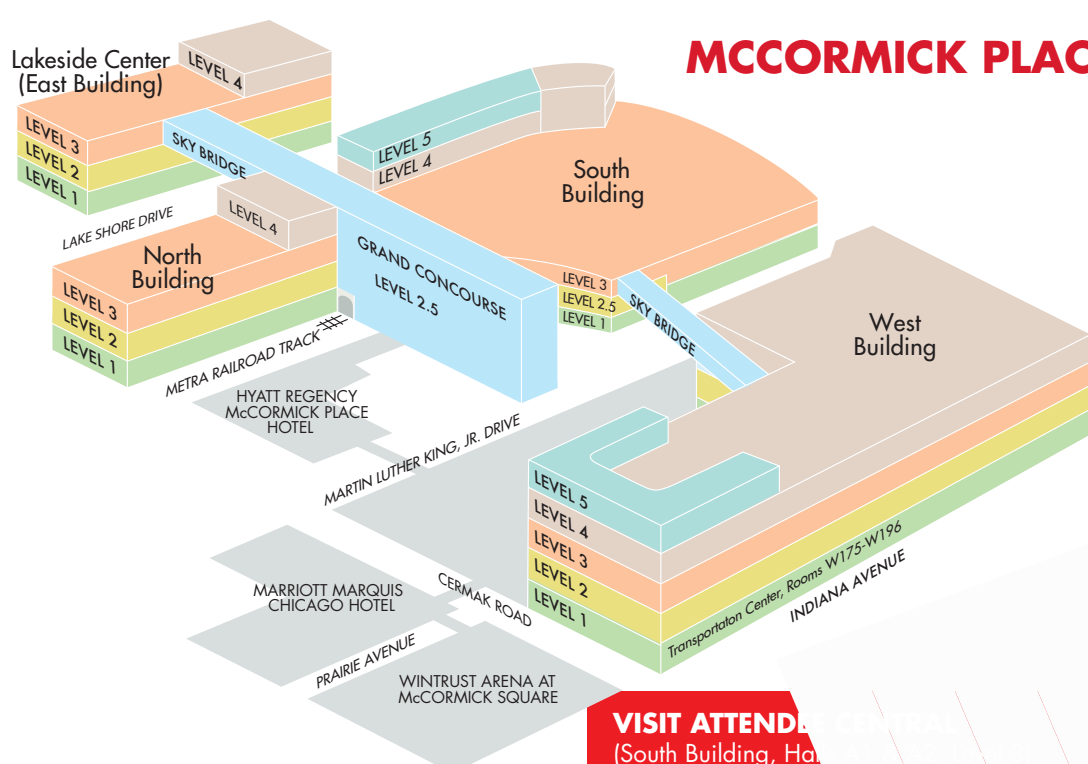

VISIT ATTENDING CENTRAL
(South Building, Hall 3000)
FRIDAY-SUNDAY, NOV. 9-11
MONDAY, NOV. 12: 8 a.m.-5 p.m.